

Modular 100: bolt instructions

Modular 100 channels are designed to be bolted together on site, for ease of transportation and installation. Below provides a guide on how to securely bolt the units together.

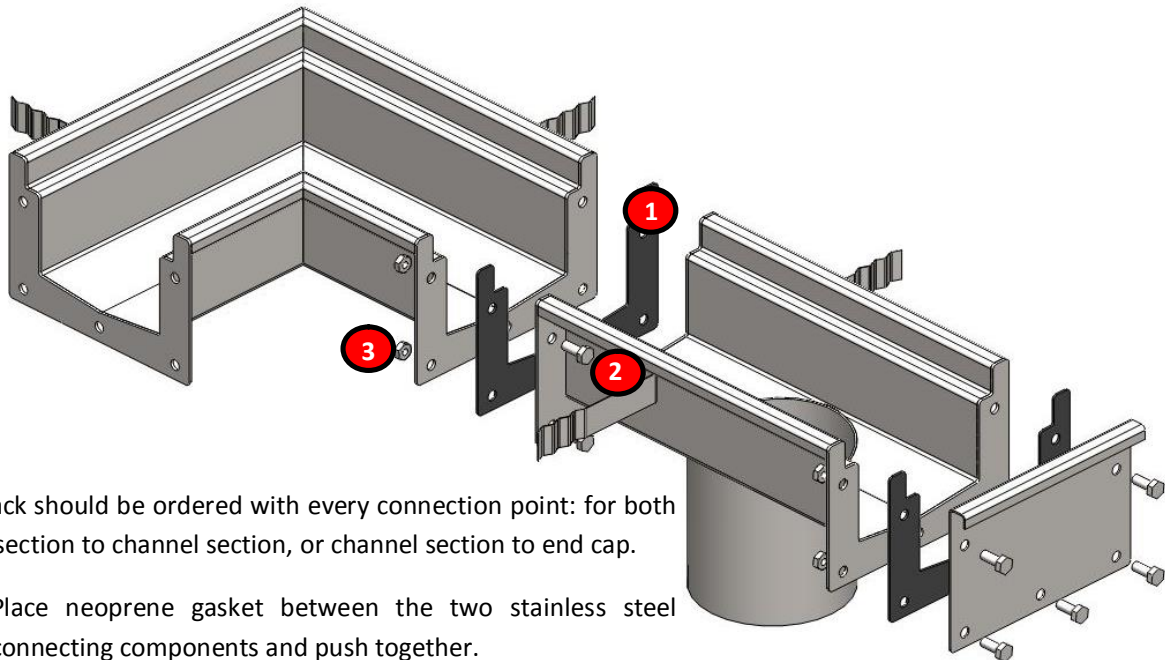

A bolt pack should be ordered with every connection point: for both channel section to channel section, or channel section to end cap.

1. Place neoprene gasket between the two stainless steel connecting components and push together.
2. Place bolts through provided holes on either side of the connection point
3. Use the nut provided to secure in place.
4. Repeat on all 5 connection holes.
5. Ensure bolts are firmly tightened, once fully tightened; the neoprene gasket should be 1mm thick.

Note: The concrete ties, for security in transportation, will be flush against the channel. During installation, pull out concrete ties as required.

Typical Installation Details

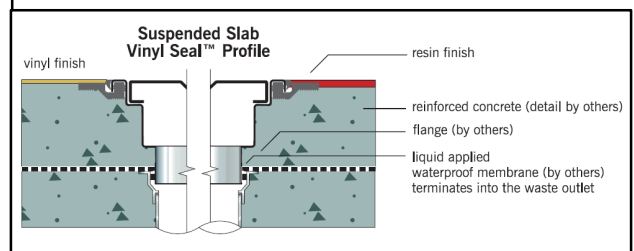
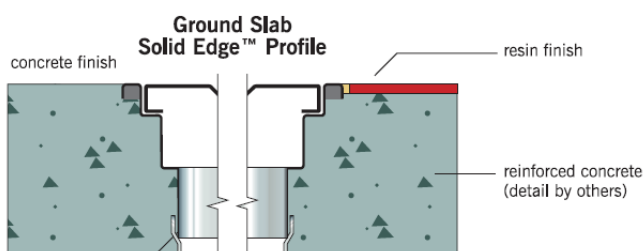
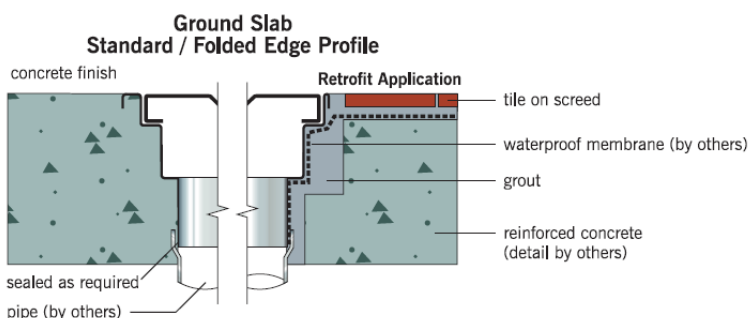

Vinyl Seal Installation

Step 1

Remove channel protective tape prior to fixing extrusion.



Step 2

Cut grey rigid extrusion to suit ensuring any mitres are cut accurately otherwise pressure points may appear in the finished floor in use.

Step 3

Using Sheet Plier Grip Wrench supplied, clip the vinyl seal rigid extrusion to underside of channel



Step 4

Where there are joint plates in the channel run cut a notch out of the rigid extrusion as shown to enable the extrusion to be clipped to the underside of the channel.



Step 5

Here you can see the rigid extrusion cut to suit and fitted prior to the fitting of the black flexible seal.



Step 6

Insert the black flexible seal as shown, making sure that the curved concave section of the seal faces TOWARDS the channel edge and that the groove in the flexible seal engages with the notch on the rigid extrusion. (It may help to lubricate the flexible seal when inserting using a water soluble soapy solution).



Step 7

Using the Sheet Plier Grip Wrench, proceed along the channel inserting the flexible seal.



Step 8

As can be seen when fitting around a corner, the flexible seal may be kept in one piece to minimise joints.



Step 9

Here you can see the rigid extrusion and flexible seal fitted prior to spreading / back



Step 10

Install the channel into the ground ensuring the flooring screed is flush to the top edge of the rigid extrusion. Protect the channel & seal assembly from splashes of concrete or screed.

Step 11

Depending on the installation, additional suitable fixings may be required to secure the rigid extrusion to the floor substrate. If this should be required, separately drill and countersink the rigid extrusion making sure all the fixings are finished flush with the top of the extrusion.

Step 12

Grout any voids at connecting PVC joints and mitred corners straight joints or fixings to ensure a continuous fully supported finish.

Step 13

Prior to laying the vinyl sheet flooring, peel the protective film from the rigid extrusion (a knife may be required to cut the film adjacent to the flexible seal) and ensure all surfaces are clean and dry.

Step 14

When preparing the vinyl sheet material and floor surface, apply a compatible adhesive also to the top surface of the rigid extrusion e.g. Altrofix 19 two part water resistant urethane adhesive. taking care not to apply adhesive to the flexible seal. This is to ensure the vinyl sheet floor is reliably anchored over its full area.

Step 15

Lay the sheet flooring against the flexible seal edge and prepare the welded joint between the flexible seal and vinyl sheet flooring as normal by scoring the sheet/seal joint to approximately half the depth of the sheet flooring thickness .

Either in-colour or black welding filler rod may be used to weld the joint. Remove surplus weld material from the joint using a spatula when the welded joint has cooled.